

## TYK+ 10 C/I



<b>Part number</b>	3107283
<b>Lampholder:</b>	LED
<b>Light Source:</b>	LED
<b>Wattage:</b>	7 W
<b>Finish:</b>	AN-96 / Anthracite gray / Textured
<b>Insulation class:</b>	I
<b>Degree of protection:</b>	IP66
<b>IK-J-xxIP:</b>	IK06 1.2J xx3
<b>CRI:</b>	80
<b>Kelvin:</b>	4000
<b>Power factor:</b>	$\text{COS}\phi \geq 0,9$
<b>Optic:</b>	Intensive circle reflector
<b>Optic Beam:</b>	10°
<b>Lightsource lumen output:</b>	700 lm
<b>Luminaire lumen output:</b>	560 lm
<b>L:</b>	L90
<b>B:</b>	B10
<b>Lifetime:</b>	75000 h
<b>Glass temperature:</b>	55°
<b>Ta MIN luminaire:</b>	-20°
<b>Ta MAX luminaire:</b>	40°
<b>ULR:</b>	0%



### Description

- LED floodlight for indoor and outdoor lighting, comprising:
- Die-cast aluminium housing, powder-polyester coated ISO 9227
  - Extra-clear, tempered, flat glass diffuser, screen-printed inside
  - Diffuser permanently sealed to the housing through a high-temperature resistant silicone
  - High-transparency polycarbonate lenses grant an optimized light transmission
  - High resiliency anti-ageing silicone gasket with high elastic return capacity
  - Intensive circular optic
  - Tear-proof nickelled brass cable gland M16x1.5 for cables  $\varnothing$  5 mm-  $\varnothing$  10 mm
  - Stainless steel external screws
  - Stainless steel wall-mounting bracket
  - Complete with 1 metre of cable H05RN-F 3G1 mm<sup>2</sup>
  - Graduated goniometer for aiming purposes made in stainless steel
  - The snoot accessory is compatible with versions that have C/I narrow-beam lenses
  - Photometric data measure according to UNI EN 13032-4 and IES LM-79-08

### Photometric data

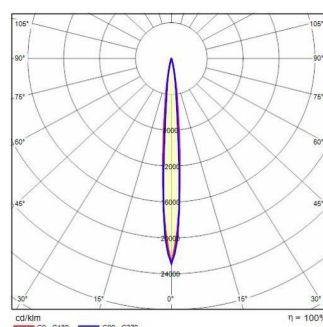

### Technical drawings

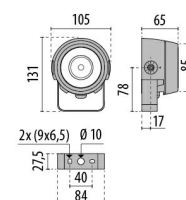

## OPTIONAL ACCESSORIES

### TYK+ 10 C/I



3107463  
Anti-glare snout  
Black

### TYK+ 10



700191  
Ground spike  
Black



3108556  
Extra rotation bracket +25°/-90°  
Stainless steel